

Existing Utilities Drawings

Appendix A

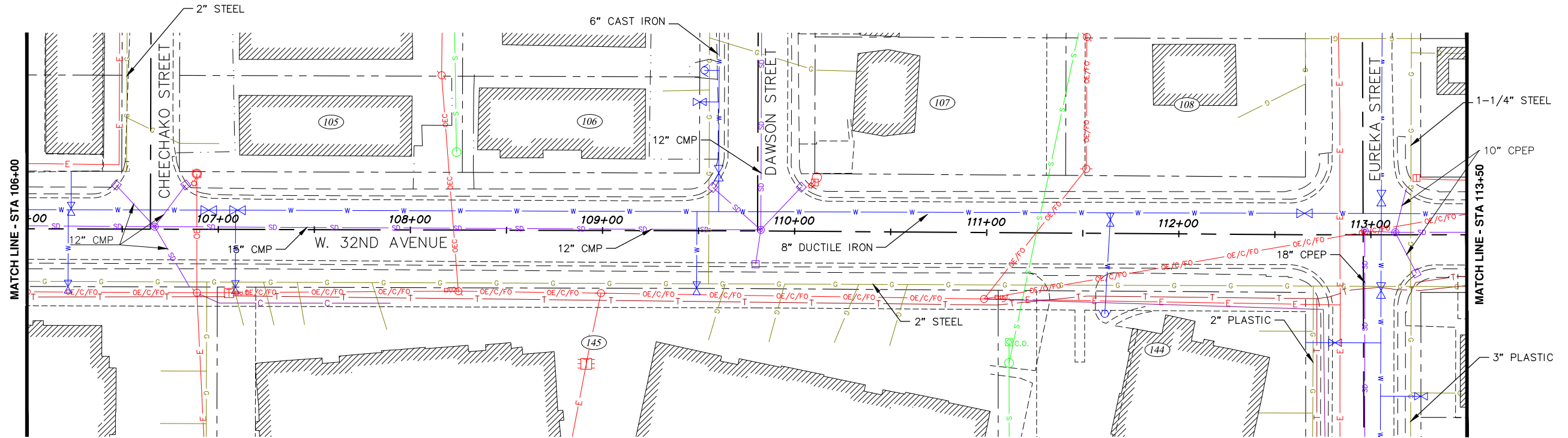
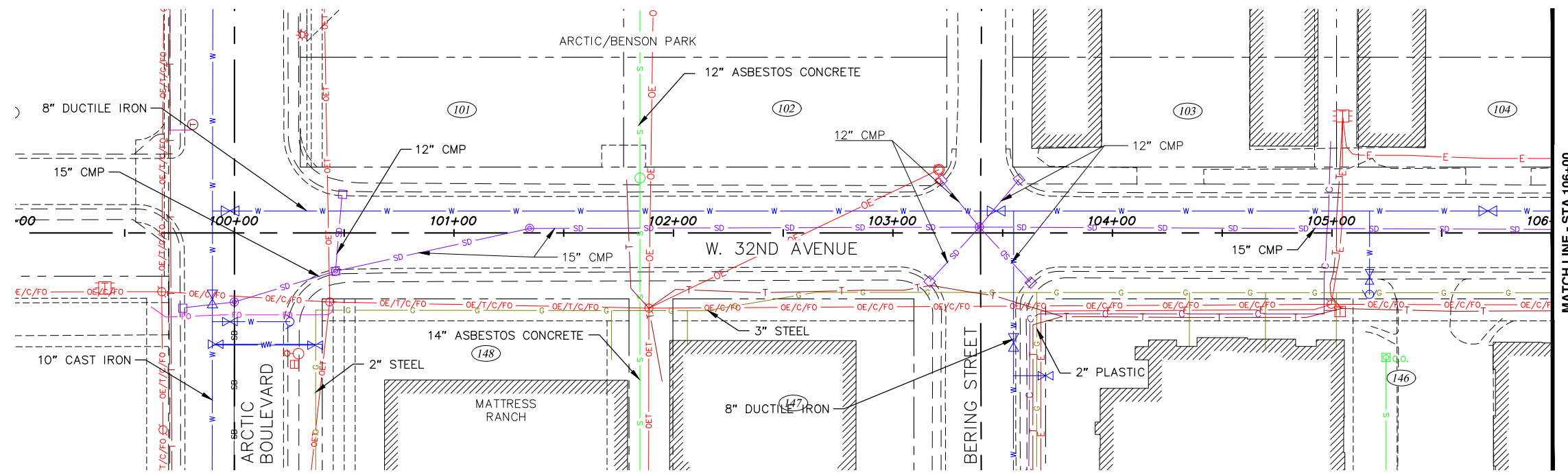

EXISTING UTILITY LEGEND

- | | | |
|--|---|---|
| <ul style="list-style-type: none"> — S SEWER — G NATURAL GAS — W WATER — SD STORM DRAIN — FO FIBER OPTIC — C CABLE TELEVISION — T TELEPHONE — E ELECTRIC — OE ELECTRIC (OVERHEAD) — OE/C/FO ELECTRIC/CABLE/FIBER OPTIC (OVERHEAD) — OE/FO ELECTRIC/FIBER OPTIC (OVERHEAD) — OEC ELECTRIC/CABLE (OVERHEAD) — OET ELECTRIC/TELEPHONE (OVERHEAD) — OE/T/C/FO ELECTRIC/TELEPHONE/CABLE/FIBER OPTIC (OVERHEAD) | <ul style="list-style-type: none"> ○ SANITARY SEWER MANHOLE ○ SANITARY SEWER SERVICE ○ SEWER CLEANOUT ○ KEY BOX ○ FIRE HYDRANT ○ WATER VALVE ○ STORM DRAIN CLEANOUT ○ STORM DRAIN CATCH BASIN ○ STORM DRAIN MANHOLE ○ CATCH BASIN MANHOLE ○ FIBER OPTIC VAULT ○ CABLE PEDESTAL ○ TELEPHONE PEDESTAL ○ TELEPHONE MANHOLE | <ul style="list-style-type: none"> ○ ELECTRIC JBOX ○ ELECTRIC SWITCH CABINET ○ LUMINAIRE ○ POWERLINE POLE ○ GUY WIRE ○ ELECTRIC JUNCTION BOX TYPE 3 ○ TRAFFIC SIGNAL POLE ○ TELEPHONE VAULT ○ LOAD CENTER ○ TRAFFIC CONTROLLER CABINET ○ JUNCTION BOX TYPE 1 (LIGHTING/TRAFFIC) ○ JUNCTION BOX TYPE 2 (LIGHTING/TRAFFIC) ○ TRANSFORMER ○ ELECTRIC MANHOLE ○ PARCEL NUMBER |
|--|---|---|



CRW
ENGINEERING GROUP, LLC
3940 ARCTIC BLVD, SUITE 300
ANCHORAGE, ALASKA 99503
PHONE: (907) 562-3252
#AEC1882-AR



PROJECT MANAGEMENT AND ENGINEERING DEPARTMENT	
16-29	W. 32ND AVE & E. 33RD AVE UPGRADES ARCTIC BOULEVARD TO OLD SEWARD HIGHWAY
EXISTING UTILITIES	
SCALE HOR. 1"=30'	GRID SW630, SW631
VER. N/A	DATE DEC 2017 STATUS DSR
SHEET	A1 of A5

File: s:\jobdata\10138.00 W 32nd Ave Upgrade\00 CADD\02 Figures\01 DSR\10138.00 Existing Utilities.dwg

File: E:\JobsData\10138.00 W 32nd Ave E 33rd Avenue Upgrade\00 CADD\02 Figures\01 DSR\10138.00 Existing Utilities.dwg

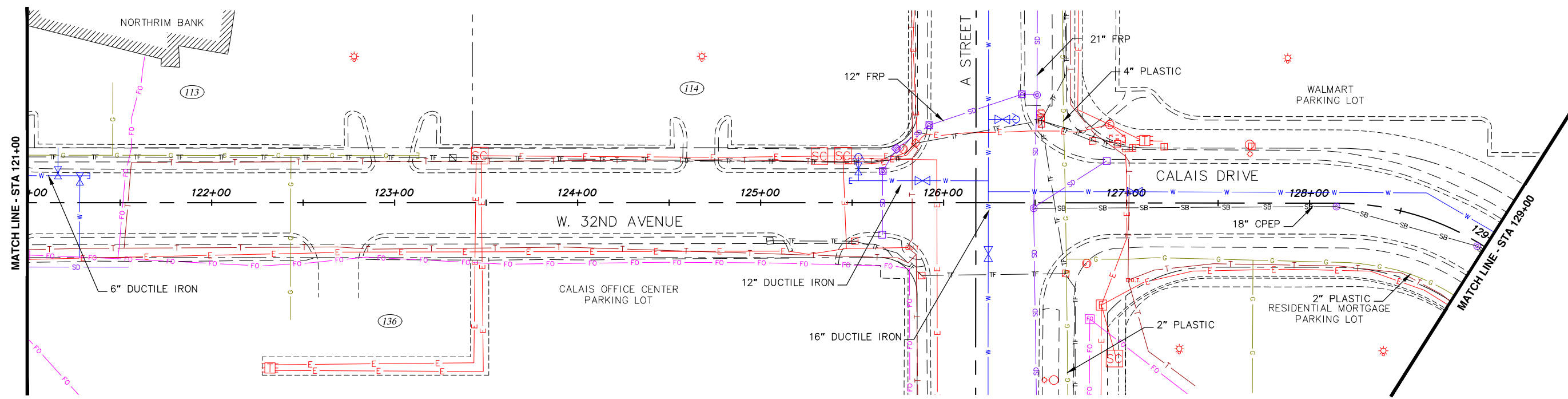
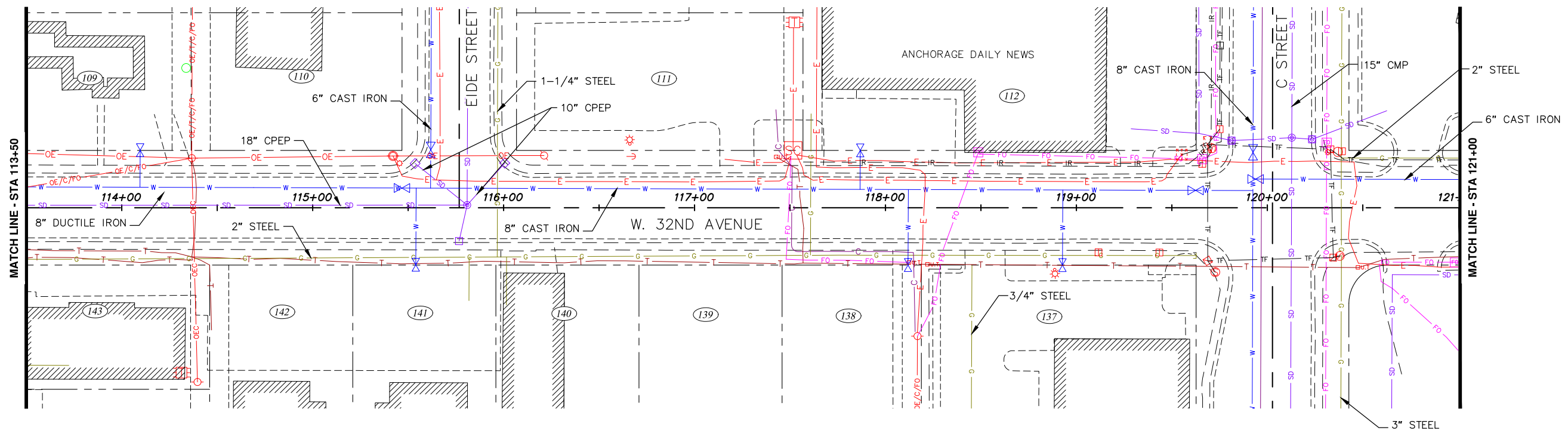

EXISTING UTILITY LEGEND

- | | | |
|---|--|---|
| <ul style="list-style-type: none"> S SEWER G NATURAL GAS W WATER SD STORM DRAIN FO FIBER OPTIC C CABLE TELEVISION T TELEPHONE E ELECTRIC OE ELECTRIC (OVERHEAD) OE/C/FO ELECTRIC/CABLE/FIBER OPTIC (OVERHEAD) OE/FO ELECTRIC/FIBER OPTIC (OVERHEAD) OEC ELECTRIC/CABLE (OVERHEAD) OET ELECTRIC/TELEPHONE (OVERHEAD) OE/T/C/FO ELECTRIC/TELEPHONE/CABLE/FIBER OPTIC (OVERHEAD) | <ul style="list-style-type: none"> ○ SANITARY SEWER MANHOLE ○ SANITARY SEWER SERVICE ○ SEWER CLEANOUT ○ KEY BOX ○ FIRE HYDRANT ○ WATER VALVE ○ STORM DRAIN CLEANOUT ○ STORM DRAIN MANHOLE ○ CATCH BASIN MANHOLE ○ FIBER OPTIC VAULT ○ CABLE PEDESTAL ○ TELEPHONE PEDESTAL ○ TELEPHONE MANHOLE | <ul style="list-style-type: none"> □ ELECTRIC JBOX □ ELECTRIC SWITCH CABINET □ LUMINAIRE □ POWERLINE POLE □ GUY WIRE □ ELECTRIC JUNCTION BOX TYPE 3 □ TRAFFIC SIGNAL POLE □ TELEPHONE VAULT □ LOAD CENTER □ TRAFFIC CONTROLLER CABINET □ JUNCTION BOX (LIGHTING/TRAFFIC) □ JUNCTION BOX TYPE 2 (LIGHTING/TRAFFIC) □ TRANSFORMER □ ELECTRIC MANHOLE □ PARCEL NUMBER |
|---|--|---|



CRW
ENGINEERING GROUP, LLC
3940 ARCTIC BLVD, SUITE 300
ANCHORAGE, ALASKA 99503
PHONE: (907) 562-3252
#AECLE882-AK

CONSULTANT

SEAL

PROJECT MANAGEMENT AND ENGINEERING DEPARTMENT
16-29 W. 32ND AVE & E. 33RD AVE UPGRADES
ARCTIC BOULEVARD TO OLD SEWARD HIGHWAY
EXISTING UTILITIES

SCALE HOR. 1"=30'
VER. N/A

GRID SW630, SW631
DATE DEC 2017 STATUS DSR

A2 of A5
SHEET

File: s:\webdata\10138.00 W 32nd And E 33rd Avenue Upgrade\00 CADD\02 Figures\01 DSR\10138.00 Existing Utilities.dwg

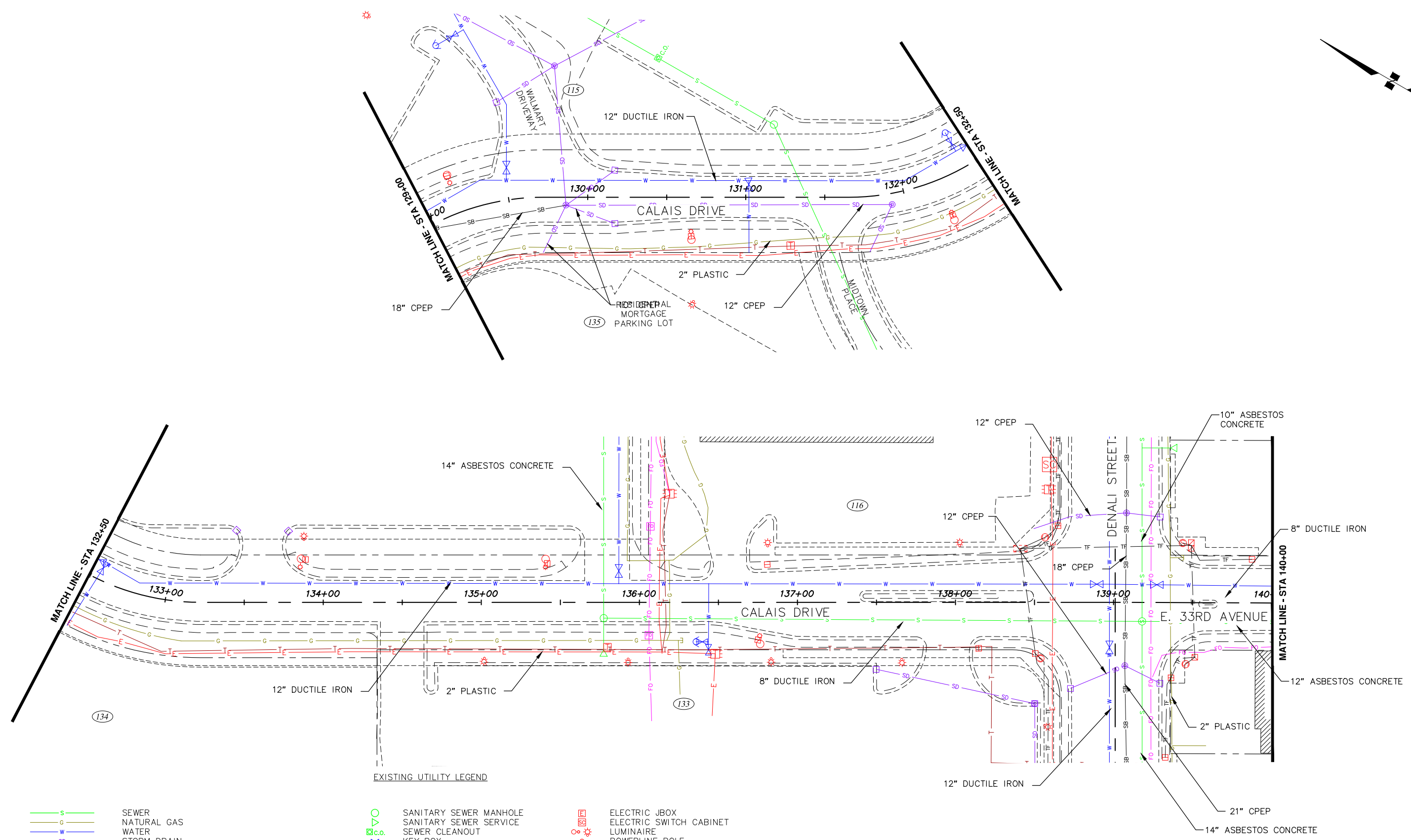

- | | | | |
|--|---|--|-------------------------|
| | SEWER | | SANITARY SEWER MANHOLE |
| | NATURAL GAS | | SANITARY SEWER SERVICE |
| | WATER | | SEWER CLEANOUT |
| | STORM DRAIN | | KEY BOX |
| | FIBER OPTIC | | FIRE HYDRANT |
| | CABLE TELEVISION | | WATER VALVE |
| | TELEPHONE | | STORM DRAIN CLEANOUT |
| | ELECTRIC | | STORM DRAIN CATCH BASIN |
| | ELECTRIC (OVERHEAD) | | STORM DRAIN MANHOLE |
| | ELECTRIC/CABLE/FIBER OPTIC (OVERHEAD) | | CATCH BASIN MANHOLE |
| | ELECTRIC/FIBER OPTIC (OVERHEAD) | | FIBER OPTIC VAULT |
| | ELECTRIC/CABLE (OVERHEAD) | | CABLE PEDESTAL |
| | ELECTRIC (OVERHEAD) | | TELEPHONE PEDESTAL |
| | ELECTRIC/TELEPHONE/CABLE/FIBER OPTIC (OVERHEAD) | | TELEPHONE MANHOLE |

EXISTING UTILITY LEGEND

- | | |
|--|--|
| | ELECTRIC JBOX |
| | ELECTRIC SWITCH CABINET |
| | LUMINAIRE |
| | POWERLINE POLE |
| | GUY WIRE |
| | ELECTRIC JUNCTION BOX TYPE 3 |
| | TRAFFIC SIGNAL POLE |
| | TELEPHONE VAULT |
| | LOAD CENTER |
| | TRAFFIC CONTROLLER CABINET |
| | JUNCTION BOX (LIGHTING/TRAFFIC) |
| | JUNCTION BOX TYPE 2 (LIGHTING/TRAFFIC) |
| | TRANSFORMER |
| | ELECTRIC MANHOLE |
| | PARCEL NUMBER |



CRW
ENGINEERING GROUP, LLC
3940 ARCTIC BLVD, SUITE 300
ANCHORAGE, ALASKA 99503
PHONE: (907) 562-3252
#AECLE882-AR

SEAL

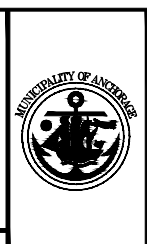

PROJECT MANAGEMENT AND ENGINEERING DEPARTMENT
16-29 W. 32ND AVE & E. 33RD AVE UPGRADES
ARCTIC BOULEVARD TO OLD SEWARD HIGHWAY
EXISTING UTILITIES

SCALE HOR. 1"=30'	GRID SW630, SW631
VER. N/A	DATE DEC 2017 STATUS DSR

A3 of A5

File: E:\JobsData\10138.00 W 32nd And E 33rd Avenue Upgrade\00 CADD\02 Figures\01 DSR\10138.00 Existing Utilities.dwg

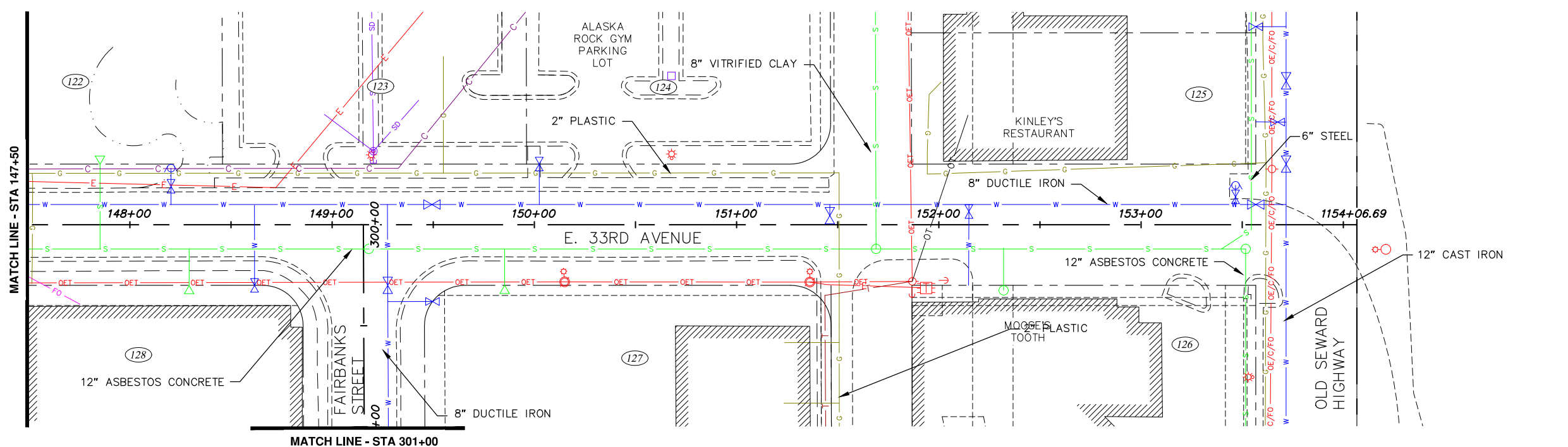
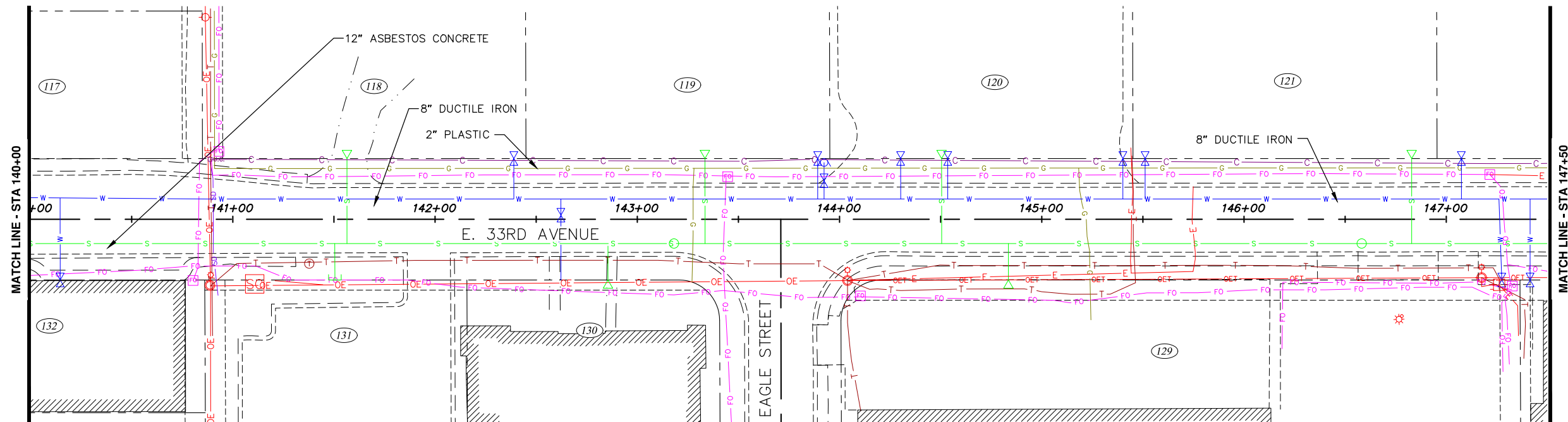

EXISTING UTILITY LEGEND

- | | | |
|--|---|--|
| <ul style="list-style-type: none"> — S SEWER — C NATURAL GAS — W WATER — SD STORM DRAIN — FO FIBER OPTIC — C CABLE TELEVISION — T TELEPHONE — E ELECTRIC — OE ELECTRIC (OVERHEAD) — OE/C/FO ELECTRIC/CABLE/FIBER OPTIC (OVERHEAD) — OE/FO ELECTRIC/FIBER OPTIC (OVERHEAD) — OEC ELECTRIC/CABLE (OVERHEAD) — OET ELECTRIC/TELEPHONE (OVERHEAD) — OE/T/C/FO ELECTRIC/TELEPHONE/CABLE/FIBER OPTIC (OVERHEAD) | <ul style="list-style-type: none"> ○ SANITARY SEWER MANHOLE ▽ SANITARY SEWER SERVICE □ SEWER CLEANOUT ○ KEY BOX ○ FIRE HYDRANT ○ WATER VALVE □ STORM DRAIN CLEANOUT □ STORM DRAIN CATCH BASIN □ STORM DRAIN MANHOLE □ CATCH BASIN MANHOLE □ FIBER OPTIC VAULT □ CABLE PEDESTAL □ TELEPHONE PEDESTAL ○ TELEPHONE MANHOLE | <ul style="list-style-type: none"> □ ELECTRIC JBOX □ ELECTRIC SWITCH CABINET ○ LUMINAIRE ○ POWERLINE POLE ○ GUY WIRE □ ELECTRIC JUNCTION BOX TYPE 3 □ TRAFFIC SIGNAL POLE □ TELEPHONE VAULT □ LOAD CENTER □ TRAFFIC CONTROLLER CABINET □ JUNCTION BOX (LIGHTING/TRAFFIC) □ JUNCTION BOX TYPE 2 (LIGHTING/TRAFFIC) □ TRANSFORMER ○ ELECTRIC MANHOLE ○ PARCEL NUMBER |
|--|---|--|





CRW
ENGINEERING GROUP, LLC

3940 ARCTIC BLVD, SUITE 300
ANCHORAGE, ALASKA 99503
PHONE: (907) 562-3252
#AEC1882-AR

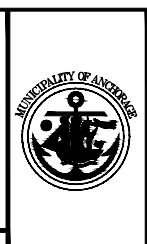

PROJECT MANAGEMENT AND ENGINEERING DEPARTMENT	
16-29	W. 32ND AVE & E. 33RD AVE UPGRADES ARCTIC BOULEVARD TO OLD SEWARD HIGHWAY
EXISTING UTILITIES	
SCALE HOR. 1"=30' VER. N/A	GRID SW630, SW631 DATE DEC 2017 STATUS DSR
SHEET A4 of A5	

File: E:\JobsData\10138.00 W 32nd And E 33rd Avenue Upgrade\00 CADD\02 Figures\01 DSR\10138.00 Existing Utilities.dwg

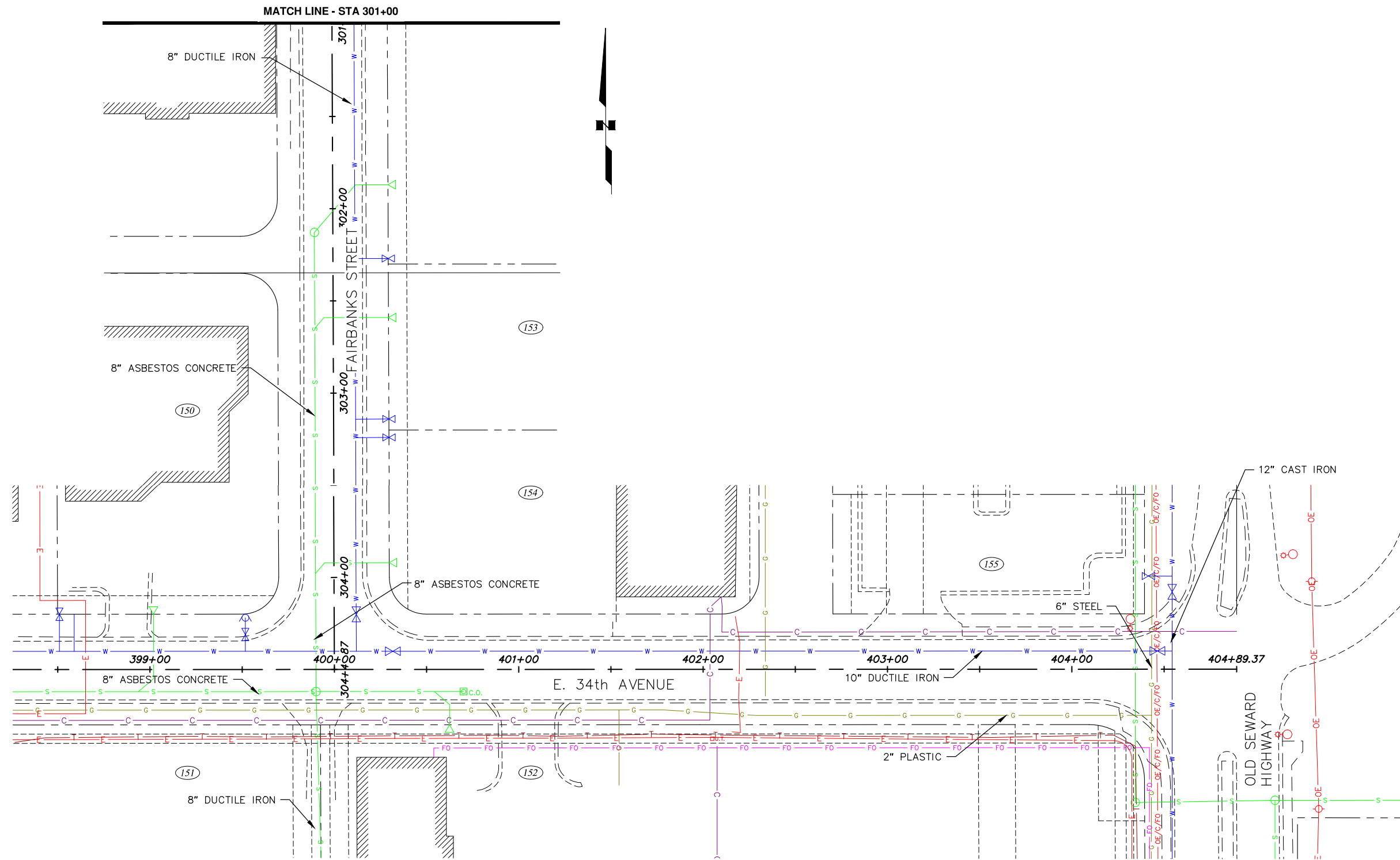

EXISTING UTILITY LEGEND

- S SEWER
- G NATURAL GAS
- W WATER
- SD STORM DRAIN
- FO FIBER OPTIC
- C CABLE TELEVISION
- T TELEPHONE
- E ELECTRIC
- OE ELECTRIC (OVERHEAD)
- OE/C/FO ELECTRIC/CABLE/FIBER OPTIC (OVERHEAD)
- OE/FO ELECTRIC/FIBER OPTIC (OVERHEAD)
- OEC ELECTRIC/CABLE (OVERHEAD)
- OET ELECTRIC/TELEPHONE (OVERHEAD)
- OE/T/C/FO ELECTRIC/TELEPHONE/CABLE/FIBER OPTIC (OVERHEAD)

- SANITARY SEWER MANHOLE
- ▽ SANITARY SEWER SERVICE
- SEWER CLEANOUT
- KEY BOX
- FIRE HYDRANT
- WATER VALVE
- STORM DRAIN CLEANOUT
- STORM DRAIN CATCH BASIN
- STORM DRAIN MANHOLE
- CATCH BASIN MANHOLE
- FIBER OPTIC VAULT
- CABLE PEDESTAL
- TELEPHONE PEDESTAL
- TELEPHONE MANHOLE

- ELECTRIC JBOX
- ELECTRIC SWITCH CABINET
- LUMINAIRE
- POWERLINE POLE
- GU⁹⁰ WIRE
- ELECTRIC JUNCTION BOX TYPE 3
- TRAFFIC SIGNAL POLE
- TELEPHONE VAULT
- LOAD CENTER
- TRAFFIC CONTROLLER CABINET
- JUNCTION BOX (LIGHTING/TRAFFIC)
- JUNCTION BOX TYPE 2 (LIGHTING/TRAFFIC)
- TRANSFORMER
- ELECTRIC MANHOLE
- PARCEL NUMBER



CRW
ENGINEERING GROUP, LLC
3940 ARCTIC BLVD, SUITE 300
ANCHORAGE, ALASKA 99503
PHONE: (907) 562-3252
#AEC1882-AR

CONSULTANT

SEAL

PROJECT MANAGEMENT AND ENGINEERING DEPARTMENT	
16-29	W. 32ND AVE & E. 33RD AVE UPGRADES ARCTIC BOULEVARD TO OLD SEWARD HIGHWAY
EXISTING UTILITIES	
SCALE HOR. 1"=30' VER. N/A	GRID SW1630, SW1631 DATE DEC 2017 STATUS DSR
SHEET A5 of A5	